

+34 695 577 651



info@lw-estates.com

Terraced Townhouse in Atalaya

Reference: R5228539



Bedrooms: 4

Bathrooms: 3

M²: 188

Price: 875,000 €

Status: Sale

Property Type: Terraced
Townhouse

Parking places: by request

Printing day : 22nd
December 2025

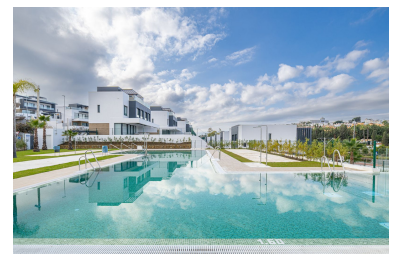
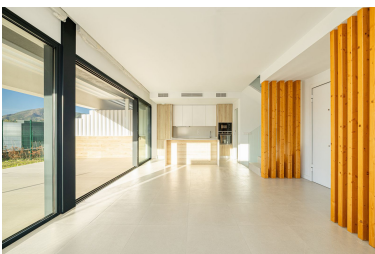



Overview: Brand-new contemporary 4-bedroom semi-detached townhouse located in the exclusive Atalaya Golf area, perfectly positioned between Marbella and Estepona. This never-before-lived-in home features a private driveway with parking, a stunning open-plan living space with a fully equipped modern kitchen, three bedrooms and two bathrooms on the main levels, plus an additional en-suite bedroom in the basement. The bright and spacious living room opens onto a west-facing terrace and private garden, ideal for enjoying the afternoon sun. A spectacular rooftop solarium offers breathtaking mountain views, creating the perfect setting for entertaining or relaxing. Within walking distance to local amenities, this property represents a unique opportunity to own a stylish modern home in one of the Costa del Sol's most sought-after locations.

Features:

New development, Pool, Air conditioning, Mountain views, None, Private garden, Parking, Luxury, Resale