

+34 695 577 651

LW
Estates

info@lw-estates.com

Terraced Townhouse in Pedregalejo

Reference: R4452574



Bedrooms: 3

Bathrooms: 2

M²: 170

Price: 995,000 €

Status: Sale

Property Type: Terraced
Townhouse

Parking places: by request

Printing day : 4th September
2025

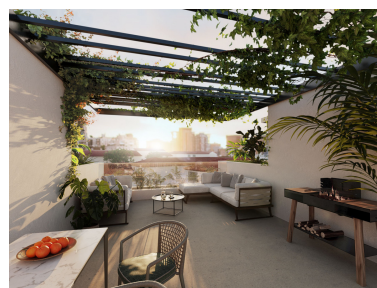



Overview:The UNIQUE project offers a total of 11 luxury semi-detached single-family homes, ranging in size from 260m² to 360m². These homes are located in an exclusive complex and feature exceptional characteristics, such as unique private patios and spacious terraces. The concept of 'patio houses' has been carefully applied in the design of these homes, meaning that the various rooms are arranged around a covered interior courtyard. This space is versatile and filled with light, making it ideal for enjoyment throughout all seasons of the year. The residential complex is situated in Pedregalejo, one of the most exclusive areas of Málaga's capital, just 500 meters from the beach. The location is privileged, as it is close to all the necessary daily services and has excellent connections to the city center and the main access routes. Additionally, it is within walking distance of schools, sports facilities, healthcare centers, shops, and a wide variety of restaurants and entertainment options. Access to public transportation is very convenient, as it is only 10 minutes from the train station and the center of Málaga, and 20 minutes from the airport. These new construction homes are exclusive and are available in 3 and 4-bedroom options, with an A energy rating, ensuring a high level of energy efficiency and savings. This is an ideal place to enjoy the cultural and gastronomic heritage of Málaga, as well as its monuments and entertainment options. For more information on availability and payment plans, please do not hesitate to get in touch with us.

Features:

Air conditioning, None