

+34 695 577 651

LW
Estates

info@lw-estates.com

Commercial in Puerto Banús

Reference: R4333858



Bedrooms: 2

Bathrooms: by request

M²: 227

Price: 1,029,000 €

Status: Sale

Property Type: Commercial Parking places: by request

Printing day : 30th
December 2025

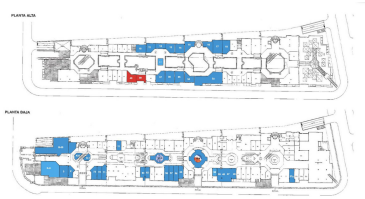

Overview: These are two units linked together. Cristamar is a mall comprising 114 local commercial units in the heart of Puerto Banus, three levels with underground parking for your clients on the ground floor restaurants, shops, and services, pharmacy at the north corner a gym, and on the second floor offices

Features:

None, Air conditioning, Lift, Investment, Resale