

+34 695 577 651

LW
Estates

info@lw-estates.com

Land in La Cala Golf

Reference: R2971553



Bedrooms: by request

Bathrooms: by request

M²: 1,715

Price: 257,250 €

Status: Sale

Property Type: Land

Parking places: by request

Printing day : 30th
December 2025



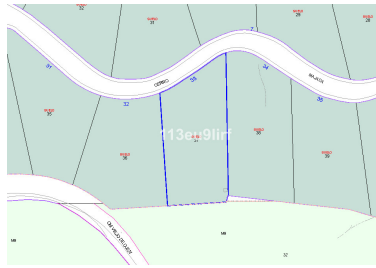

Overview: Residential plot in La Cala Golf offering panoramic mountain and golf views. Current building regulations allow to build a detached villa of 343 m2 + basement + uncovered terraces + pool. Water, electricity and sewage connections all in place.

Features:

24H Security